



## ACF-100-440

ACF-100-440, Power capacitor with contactor and fuses

Code: R3S4D1. DESCATALOGADO

- > Fuses (A): 160
- > Cable section (mm<sup>2</sup>): 70
- > In (A): 131
- > kvar (400 V): 80
- > kvar (440 V): 100
- > Cut off power: 120 kA
- > Use voltage (V): 440
- > Type of protection: contactor and fuse

### Description

The fixed capacitors of the ACF series are single-step units that have been designed for Power factor correction procedures under constant load.

### Application

Its application is mainly focused on the compensation of motors, transformers and installations under constant load, providing a signal that connects to the capacitor with a contactor switching operation.



# ACF-100-440

CS Capacitor with contactor and fuses

Code: R3S4D1.

## Specifications

### Electrical characteristics

Discharge resistance	75 V / 3 min
Surge	10 % 8 h over 24 h 15 % up to 15 min over 24 hours 20 % up to 5 min over 24 hours 30 % up to 1 min over 24 hours
Manoeuvre voltage	Contactors: 230 V
Reinforcement voltage	400 V
Tolerance C	± 10 % sobre la capacidad
Voltage	400 V
Insulation voltage, circuit	3 kV

### Mechanical characteristics

Size (mm) width x height x depth	360 x 1004 x 196 (mm)
Envelope	RAL 7035 Grey / RAL 3005 Garnet
Fastening	Vertical
Ventilation	Natural
Weight (kg)	29

### Environmental characteristics

Protection class	IP 21
Relative humidity (without condensation)	80%
Working temperature	T° class D: Daily average: 45 °C, annual average: 35 °C, maximum: 50 °C, minimum: -25 °C

### Standards

Certifications	VDE 560
Electrical safety, Maximum height (m)	2000
Standards	IEC 60831-1, IEC 70/7, UNE-EN 20827, UNE-EN 20010, BS 1650

### Current measurement circuit

Permanent overload	1,3 In
--------------------	--------

### Features / performance

Components	CS capacitor Contactors with pre-insertion block and fast discharge resistor Protection at header via high cut-off power fuses (APR)
------------	---

Switch and cable cross-section for installations with Un= 400 V. The installation company must ensure compliance with the low voltage directive at all times, in accordance with the particularities of each installation and type of cable



# ACF-100-440

CS Capacitor with contactor and fuses

Code: R3S4D1.

## Dimensions

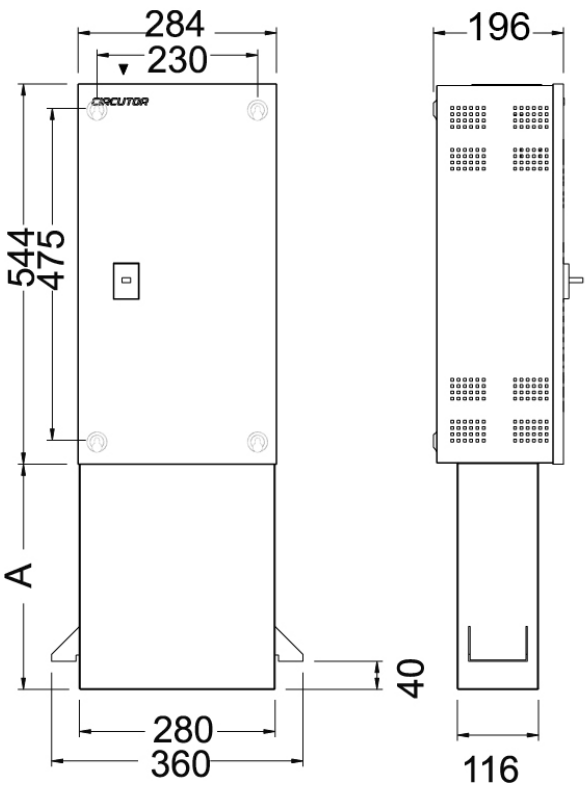

	A
ACF-40/CCF-40	324
ACF-60/CCF-60	549
ACF-80/CCF-80	699