



ACF-30-230

ACF-30-230, Power capacitor with contactor and fuses

Code: R3S161. **DESCATALOGADO**

- > Fuses (A): 160
- > Cable section (mm²): 50
- > In (A): 75
- > kvar (230 V): 30
- > Cut off power: 120 kA
- > Use voltage (V): 230
- > Type of protection: contactor and fuse

Description

The fixed capacitors of the ACF series are single-step units that have been designed for Power factor correction procedures under constant load.

Application

Its application is mainly focused on the compensation of motors, transformers and installations under constant load, providing a signal that connects to the capacitor with a contactor switching operation.



ACF-30-230

CS Capacitor with contactor and fuses

Code: R3S161.

Specifications

Electrical characteristics

Discharge resistance	75 V / 3 min
Surge	10 % 8 h over 24 h 15 % up to 15 min over 24 hours 20 % up to 5 min over 24 hours 30 % up to 1 min over 24 hours
Manoeuvre voltage	Contactors: 230 V
Reinforcement voltage	400 V
Tolerance C	± 10 % sobre la capacidad
Voltage	230 V
Insulation voltage, circuit	3 kV

Mechanical characteristics

Size (mm) width x height x depth	360 x 1004 x 196 (mm)
Envelope	RAL 7035 Grey / RAL 3005 Garnet
Fastening	Vertical
Ventilation	Natural
Weight (kg)	22

Environmental characteristics

Protection class	IP 21
Relative humidity (without condensation)	80%
Working temperature	T° class D: Daily average: 45 °C, annual average: 35 °C, maximum: 50 °C, minimum: -25 °C

Standards

Certifications	VDE 560
Electrical safety, Maximum height (m)	2000
Standards	IEC 60831-1, IEC 70/7, UNE-EN 20827, UNE-EN 20010, BS 1650

Current measurement circuit

Permanent overload	1,3 In
--------------------	--------

Features / performance

Components	CS capacitor Contactors with pre-insertion block and fast discharge resistor Protection at header via high cut-off power fuses (APR)
------------	---

Switch and cable cross-section for installations with Un= 400 V. The installation company must ensure compliance with the low voltage directive at all times, in accordance with the particularities of each installation and type of cable



ACF-30-230

CS Capacitor with contactor and fuses

Code: R3S161.

Dimensions

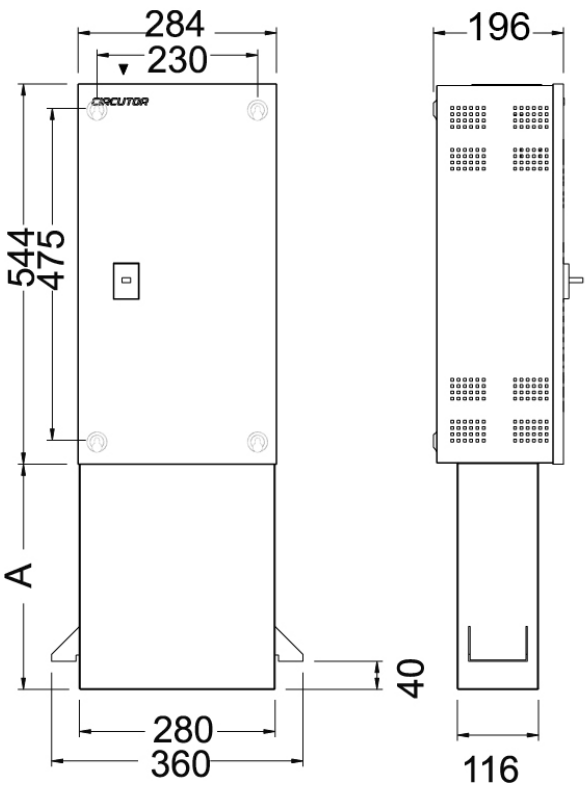

	A
ACF-40/CCF-40	324
ACF-60/CCF-60	549
ACF-80/CCF-80	699