



TC6 420 300A

TC6 420 300A, Current transformers narrow section

Code: M72136.

- > Flat strip(mm): 40 x 10
- > Inner diameter (mm): 28
- > Analog output: 4...20 mA
- > Measurement Range (A): 300
- > Input current: 300 A
- > Transformer type: Current transformer with 4 ... 20 mA converter

Description

- Needs an output power supply of 7.5 ... 36 Vdc
- Primary current: from 5 to 300 Aac, depending on the type
- Secondary current: 4 ... 20 mA
- Internal diameter: from 20 to 44 mm, depending on the type
- Busbar dimensions: from 25 x 5 mm to 60 x 12 mm

Application

Used in power lines to obtain a current proportional to the primary current rated at 0..20 mA / 4...20 mA in the secondary



TC6 420 300A

Current transformer with converter

Code: M72136.

Specifications

Auxiliary power supply

Voltage	7,5 ... 36 Vdc
---------	----------------

Electrical characteristics

Safety factor (SF)	FS < 5
--------------------	--------

Mechanical characteristics

Size (mm) width x height x depth	64 x 80,5 x 44 (mm)
Envelope	Plastic wrap V0 self-extinguishing
Weight (kg)	0,223

Environmental characteristics

Thermal Class	Class B (+130 °C)
---------------	-------------------

Specific technical characteristics of current sensors

Inner diameter Ø (mm)	28
Operating voltage	0,72 kV~ max.

Current measurement circuit

Nominal frequency	50 / 60 Hz
Primary current measurement	250 A
Dynamic current (Idyn)	2,5 Ith
Thermal short-circuit current (Ith)	60 In
Transformation ratio	4 ... 20 mA

TC-420

Current transformers with converter 4 ... 20 mA or 0 ... 20 mA

CODE	TYPE	Measurement Range (A)	Flat strip(mm)	Inner diameter (mm)
Output 4...20 mA, ext. supply 7,5...36 Vdc				
M72112.	TC5 420 5A	5	25 x 5	20
M72113.	TC5 420 10A	10	25 x 5	20
M72114.	TC5 420 20A	20	25 x 5	20
M72132.	TC6 420 100A	100	40 x 10	28
M72134.	TC6 420 200A	200	40 x 10	28
M72136.	TC6 420 300A	300	40 x 10	28
M72131.	TC6 420 50A	50	40 x 10	28
M72152.	TC8 420 1000A	1000	60 x 12	44



TC6 420 300A

Current transformer with converter

Code: M72136.

CODE	TYPE	Measurement Range (A)	Flat strip(mm)	Inner diameter (mm)
M72153.	TC8 420 1500A	1500	60 x 12	44
M72151.	TC8 420 500A	500	60 x 12	44

For greater currents, use: transformer + transducer



TC6 420 300A

Current transformer with converter

Code: M72136.

Dimensions

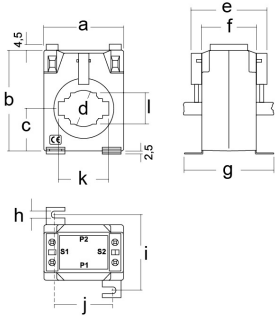

	TC 5 TCH 5	TC 5.2 TCH 5.2	TC 6.2 TCH6.2	TC 6 TCH 6	TC 8 TCH 8	TC 10 TCH 10
a	58	58	64	64	84,5	108
b	70	70	80,5	80,5	102	130
c	29	29	34	34	46	61
d	20,3	22	26	28,5	44	63
e	45	45	60,5	66,5	69	---
f	32	32	44	44	50	50
g	59	59	71	71,2	78	78
h	5,6	5,6	5,6	5,6	6,6	6,6
i	48	48	60	60	64	64
j	39	39	46	46	62	86
k	25,6	30,6	30,6	40,6	60,6	80,6
l	15,6	15,6	20,6	25,2	30,6	50,8