



## TC10 200/5

TC10 200/5, Current transformers narrow section

Code: M7037F. DESCATALOGADO

- > Flat strip(mm): 50 x 50 | 60 x 30 | 80 x 30
- > System: Single-phase
- > Class 0,5 Power (VA): 1
- > Class 1 Power (VA): 2,5
- > Class 3 Power (VA): 5
- > Measurement Range (A): 200/5
- > Input current: 200 A
- > Transformer type: Closed core

### Description

- Type: bar entrance
- Types: from 40 to 4000 A
- Internal diameter: from 20.3 to 63 mm, depending on the type
- Busbar dimensions: from 25 x 5 mm to 30 x 100 mm
- Individual certificate available on request
- DIN rail fixing accessory (Types **TC5** and **TC6**)
- Secondary coding types .../5 A (on demand .../1 A. **TC4** not available)

### Application

Converting a high nominal current to a lower current so that it can be measured by the unit. In installations where the electrical supply can be interrupted to install transformers.



## TC10 200/5

Current transformers narrow section

Code: M7037F.

### Specifications

#### Electrical characteristics

Safety factor (SF)	FS 5
Power	2.5 VA (Class 1)

#### Mechanical characteristics

Size (mm) width x height x depth	108 x 137 x 78 (mm)
Envelope	Plastic wrap V0 self-extinguishing, UL 94
Weight (kg)	0,546

#### Environmental characteristics

Thermal Class	Class B (+130 °C)
Protection class	IP 20
Relative humidity (without condensation)	15 ... 95 %

#### Specific technical characteristics of current sensors

Inner diameter $\varnothing$ (mm)	63
Operating voltage	0,72 kV~ max.

#### Current measurement circuit

Nominal frequency	50 / 60 Hz
Primary current measurement	200 A
Dynamic current (I <sub>dyn</sub> )	2,5 I <sub>th</sub>
Thermal short-circuit current (I <sub>th</sub> )	60 I <sub>n</sub>
Transformation ratio	... / 5 A

#### Standards

Standards	IEC 61869-1, IEC 61869-2, BS2627
-----------	----------------------------------

For other configurations see table of additional features



# TC10 200/5

Current transformers narrow section

Code: M7037F.

## Dimensions

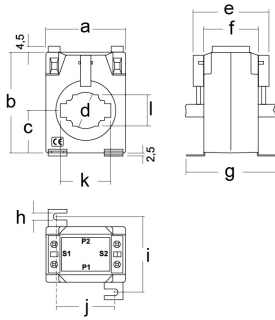

	TC 5 TCH 5	TC 5.2 TCH 5.2	TC 6.2 TCH6.2	TC 6 TCH 6	TC 8 TCH 8	TC 10 TCH 10
a	58	58	64	64	84,5	108
b	70	70	80,5	80,5	102	130
c	29	29	34	34	46	61
d	20,3	22	26	28,5	44	63
e	45	45	60,5	66,5	69	---
f	32	32	44	44	50	50
g	59	59	71	71,2	78	78
h	5,6	5,6	5,6	5,6	6,6	6,6
i	48	48	60	60	64	64
j	39	39	46	46	62	86
k	25,6	30,6	30,6	40,6	60,6	80,6
l	15,6	15,6	20,6	25,2	30,6	50,8