



## Line-M-20I

Line-M-20I, Centralizer module with 20 digital inputs

Code: M58E06. DESCATALOGADO

- > Protocol: Modbus/RTU
- > Communications: Bus-Line
- > Digital inputs: 20
- > Mounting: DIN rail

## Specifications

### AC power supply

Installation category	CAT III 300V
auxiliary power supply mode	Through the connector

### DC power supply

Consumption	3,5 W
Nominal voltage	12 Vdc

### Mechanical characteristics

Size (mm) width x height x depth	52,5 x 118 x 70 (mm)
Envelope	Self-extinguishing V0 plastic
Fastening	DIN rail (IEC 60715)
Weight (kg)	0,178

### Environmental characteristics

Protection class	IP30, Front: IP40
Relative humidity (without condensation)	5 ... 95%
Storage temperature	-20 ... +70 °C
Working temperature	-10 ... +50 °C

### Voltage measurement circuit

Input impedance	1.4 kΩ
-----------------	--------

### Standards

Electrical safety, Maximum height (m)	2000
Electrical safety, Installation category	CAT III 300 V
Standards	UNE-EN 61010-1, UNE-EN 61000-6-2, UNE-EN 61000-6-4

### User interface

LED	21 LED
-----	--------

### Digital inputs

Input/output insulation	4,2 kVcc
Quantity	20
Consumption (per input)	60 mA Eingänge AUS / 240 mA Eingänge EIN



## Line-M-20I

---

Code: M58E06.

Type	Optocoupler
Minimum signal width	10 ms
<b>Digital transistor outputs</b>	
Maximum current	120mA



# Line-M-20I

Code: M58E06.

## Dimensions

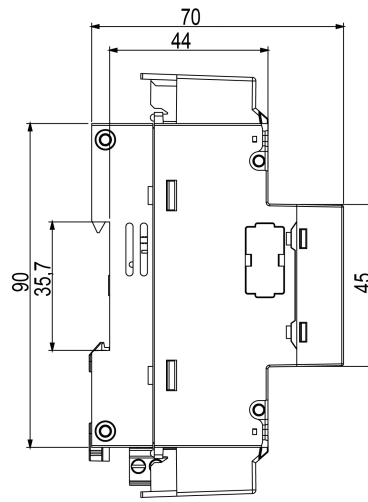
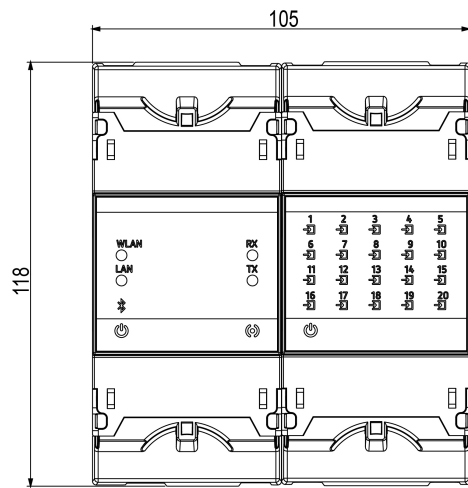

## Connections

