



## CMBUS-24

CMBUS-24, M-Bus to Modbus Converter,

Code: D80224. [CONSULTAR DISPONIBILIDAD](#)

### Description

**CMBUS** protocol transducers enable devices with RS-485 Modbus Master communications to communicate with different M-BUS slave units.

There are two unit models:

- The **CMBUS-8** model can communicate with 8 slave units (100 parameters).
- The **CMBUS-24** model can communicate with 24 slave units (500 parameters)

### Application

In Northern and Central European installations there are many devices that log consumption, equipped with M-BUS communications protocols or interfaces. These equipments measure cold and hot water consumption, as well steam, gas, electricity, etc. Said equipments deliver characteristic parameters of the systems they control, such as, water temperature, volume, flow, pressure or electrical energy consumption, as well as the more basic parameters of an electrical network. The M-BUS (BUS-Meter) protocol is a communications system for reading energy meters that has been designed to automate data collection by remote control or computer programs.



# CMBUS-24

M-Bus to Modbus Converter

Code: D80224.

## Specifications

DC power supply		
Consumption		55 mA
Nominal voltage		18 ... 30 Vdc
Mechanical characteristics		
Size (mm) width x height x depth		17,5 x 90 x 58 (mm)
Weight (kg)		0,134
Communication Network		
Protocol		Modbus RTU / M-BUS
Technology / Type		M-BUS
Standards		
Electrical safety, Maximum height (m)		2,000
Standards		EN 61000-6-3+A1,EN 61000-6-2, IEC 61000-4-3, IEC 61000-4-2, IEC 61000-4-4, IEC 61000-4-5, IEC 61000-4-6, EN 61010-1, LVD 73/23/EEC, EMC 89/336/EEC, CE 93/68/EEC
User interface		
LED		HOST LED / M-BUS LED
Serial communication		
Technology / Type		RS-232 / RS-485

CMBUS  
M-Bus to Modbus Converter

CODE	TYPE	Description
M-BUS		
D80208.	CMBUS-8	M-Bus to Modbus Converter, up to 8 Mbus slaves



## CMBUS-24

M-Bus to Modbus Converter

Code: D80224.

### Dimensions

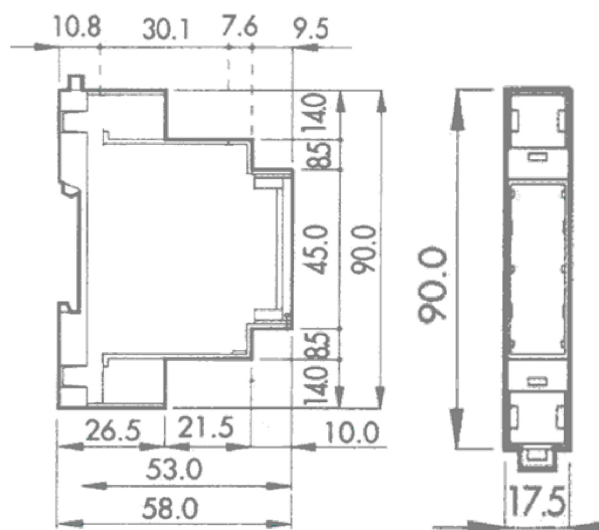

### Connections

